

**SB2 (light-duty)**

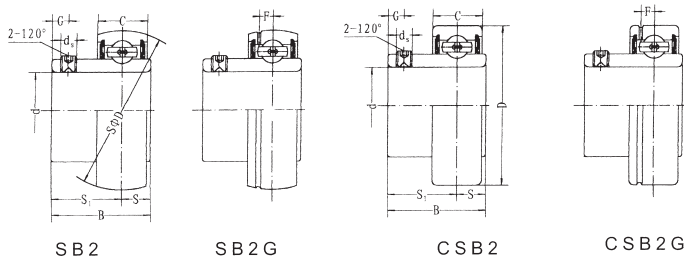

Bearing No.	Dimensions <sup>mm</sup> / <sub>inch</sub>								Bearing No.	Housing No.	Weight (kg)
	d	D	B	C	S	S <sub>1</sub>	d <sub>s</sub>	G			
SB 201	12	40	22	12	6	16	M5 x 0.8	4.5	7360	4480	0.10
SB 201-8	3/4	1.5748	0.8661	0.4724	0.236	0.630	# 10-32	0.177			0.10
SB 202	15	40	22	12	6	16	M5 x 0.8	4.5	7360	4480	0.10
SB 202-9	9/16	1.5748	0.8661	0.4724	0.236	0.630	# 10-32	0.177			0.10
SB 202-10	5/8										0.10
SB 203	17	40	22	12	6	16	M5 x 0.8	4.5	7360	4480	0.10
SB 203-11	11/16	1.5748	0.8661	0.4724	0.236	0.630	# 10-32	0.177			0.10
SB 204	20	47	25	14	7	16	M6 x 1	4.5	9880	6200	0.13
SB 204-12	3/4	1.8504	0.9843	0.5512	0.276	0.709	1/4-28 UNF	0.177			0.14
SB 205	25	52	27	15	7.5	19.5	M6 x 1	5.5	10780	6980	0.16
SB 205-13	13/16										0.19
SB 205-14	7/8	2.0472	1.0630	0.5906	0.295	0.768	1/4-28 UNF	0.217			0.18
SB 205-15	15/16										0.17
SB 205-16	1										0.16
SB 206	30	62	30	16	8	22	M6 x 1	6			14970
SB 206-17	1-1/16								0.28		
SB 206-18	1-1/8	2.4409	1.1811	0.6299	0.315	0.866	1/4-24 UNF	0.236	0.26		
SB 206-19	1-3/16								0.25		
SB 206-20	1-1/4								0.24		
SB 207	35	72	32	17	8.5	23.5	M8 x 1	6.5	19750	13670	0.36
SB 207-20	1-1/4										0.43
SB 207-21	1-5/16	2.8346	1.2598	0.6693	0.335	0.925	5/16-24 UNF	0.256			0.41
SB 207-22	1-3/8										0.38
SB 207-23	1-7/16										0.37
SB 208	40	80	34	18	9	25	M8 x 1	7	22710	15940	0.60
SB 208-24	1-1/2	3.1496	1.3386	0.7087	0.354	0.984	5/16-24 UNF	0.276			0.58
SB 208-25	1-9/16										0.60
SB 209	45	85	41.2	19	10.2	31	M8 x 1	8.2	24360	17710	0.80
SB 209-26	1-5/8										
SB 209-27	1-11/16	3.3465	1.6220	0.7480	0.402	1.220	5/16-24 UNF	0.323			
SB 209-28	1-3/4										
SB 210	50	90	43.5	20	10.9	32.6	M10 x 1	9.2	26980	19840	0.80
SB 210-29	1-13/16										
SB 210-30	1-7/8	3.5433	1.7125	0.7874	0.429	1.283	3/8-24 UNF	0.362			
SB 210-31	1-15/16										
SB 210-32	2										
SB 211	55	100	45.3	21	11.8	33.5	M10 x 1	9.8	33370	25110	1.1
SB 211-32	2										
SB 211-33	2-1/16	3.9370	1.7835	0.8268	0.465	1.319	3/8-24 UNF	0.386			
SB 211-34	2-1/8										
SB 211-35	2-3/16										
SB 212	60	110	53.7	22	14.9	38.8	M10 x 1	9.8	36740	27970	1.30
SB 212-36	2-1/4										
SB 212-37	2-5/16	4.3307	2.1142	0.8661	0.587	1.528	3/8-24 UNF	0.386			
SB 212-38	2-3/8										
SB 212-39	2-7/16										