

UCHA 2 (normal-duty)

**Screw Conveyor
Hanger Units**

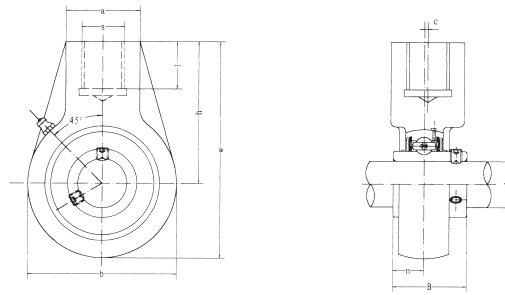

Unit No.	Dimensions <small>mm inch</small>										Bearing No.	Housing No.	Weight (kg)
	d	h	w	b	c	a	S	I	B	n			
UCHA 201	12	64	96	64	0	40		19	31	12.7	UC 201	HA204	0.73
UCHA 201-8	3/4										UC 201-8		0.72
UCHA 202	15										UC 202		0.72
UCHA 202-9	9/16										UC 202-9		0.72
UCHA 202-10	5/8	2-33/64	3-25/32	2-33/64	0	1-37/64	G-3/4	3/4	1.2205	0.500	UC 202-10		0.72
UCHA 203	17										UC 203		0.71
UCHA 203-11	11/16										UC 203-11		0.70
UCHA 204	20										UC 204		0.69
UCHA 204-12	3/4										UC 204-12	0.69	
UCHA 205	25	64	103	78	0	40		19	34.1	14.3	UC 205	HA205	0.83
UCHA 205-13	13/16										UC 205-13		0.87
UCHA 205-14	7/8	2-33/64	4-1/16	3-5/64	0	1-37/64	G-3/4	3/4	1.3425	0.563	UC 205-14		0.86
UCHA 205-15	15/16										UC 205-15		0.84
UCHA 205-16	1										UC 205-16		0.83
UCHA 206	30	64	103	78	0	40		19	38.1	15.9	UC 206	HA206	0.83
UCHA 206-17	1-1/16										UC 206-17		0.86
UCHA 206-18	1-1/8	2-33/64	4-1/16	3-5/64	0	1-37/64	G-3/4	3/4	1.5000	0.626	UC 206-18		0.85
UCHA 206-19	1-3/16										UC 206-19		0.83
UCHA 206-20	1-1/4										UC 206-20		0.82
UCHA 207	35	70	116	92	0	40		19	42.9	17.5	UC 207	HA207	1.16
UCHA 206-20	1-1/4										UC 207-20		1.22
UCHA 207-21	1-5/16	2-3/4	4-9/16	3-5/8	0	1-37/64	G-3/4	3/4	1.6890	0.689	UC 207-21		1.19
UCHA 207-22	1-3/8										UC 207-22		1.16
UCHA 207-23	1-7/16										UC 207-23		1.13
UCHA 208	40	73	121	96	2	40		19	49.2	19	UC 208	HA208	1.32
UCHA 208-24	1-1/2	2-7/8	4-49/64	3-25/32	5/64	1-37/64	G-3/4	3/4	1.9370	0.748	UC 208-24		1.36
UCHA 208-25	1-9/16										UC 208-25		1.33
UCHA 209	45	82	136	108	5	48		21	49.2	19	UC 209	HA209	1.92
UCHA 209-26	1-5/8										UC 209-26		2.02
UCHA 209-27	1-11/64	3-15/64	5-23/64	4-1/4	13/64	1-57/64	G-1	53/64	1.9370	0.748	UC 209-27		1.98
UCHA 209-28	1-3/4										UC 209-28		1.94
UCHA 210	50	83	142	118	5	48		21	51.6	19	UC 210	HA210	1.90
UCHA 210-29	1-13/16										UC 210-29		2.02
UCHA 210-30	1-7/8	3-17/64	5-19/32	4-41/64	13/64	1-57/64	G1	53/64	2.0315	0.748	UC 210-30		1.97
UCHA 210-31	1-15/16										UC 210-31		1.92
UCHA 210-32	2										UC 210-32		1.88
UCHA 211	55	87	150	126	7	60		25	55.6	22.2	UC 211	HA211	2.61
UCHA 211-32	2										UC 211-32		2.76
UCHA 211-33	2-1/16	3-27/64	5-29/32	4-61/64	9/32	2-23/64	G1-1/4	63/64	2.1890	0.874	UC 211-33		2.70
UCHA 211-34	2-1/8										UC 211-34		2.65
UCHA 211-35	2-3/16										UC 211-35		2.59
UCHA 212	60	102	173	142	9	60		28	65.1	25.4	UC 212	HA212	3.54
UCHA 212-36	2-1/4										UC 212-36		3.67
UCHA 212-37	2-5/16										UC 212-37		3.59
UCHA 212-38	2-3/8	4-1/64	6-13/16	5-19/32	23/64	2-23/64	G1-1/4	1-7/64	2.5630	1.000	UC 212-38		3.52
UCHA 212-39	2-7/16										UC 212-39		3.45
UCHA 213	65	117	200	166	9.5	70		32	65.1	25.4	UC 213	HA213	5.80
UCHA 213-40	2-1/2	4-39/64	7-7/8	6-17/32	3/8	2-3/4	G1-1/2	1-17/64	2.5630	1.000	UC 213-40		5.89
UCHA 213-41	2-9/16										UC 213-41		5.80