

**Cartridge Units
(Adapter mounted)**

UKC 2 (normal-duty)

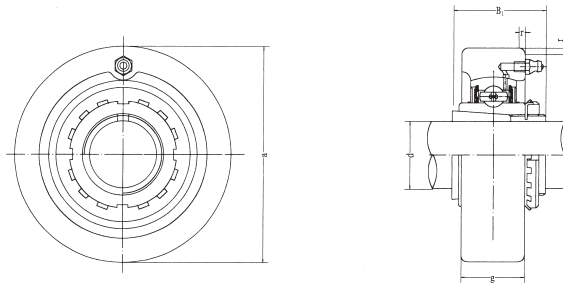

Unit No.	Dimensions ^{mm} / _{inch}					Bearing No.	Housing No.	No.	Weight (kg)
	d	a	g	r	B ₁				
UKC 205	20	80	22	2	35	UK 205	C205	H305 HE305	0.68
	³ / ₄	3.1496	⁵⁵ / ₆₄	0.079	1.378				
UKC 206	25	85	27	2	38	UK 206	C206	H306 HS306 HE306	0.84
	⁷ / ₈	3.3465	1- ¹ / ₁₆	0.079	1.496				
	1								
UKC 207	30	90	28	2	43	UK 207	C207	H307 HS307	1.02
	1- ¹ / ₈	3.5433	1- ⁷ / ₆₄	0.079	1.693				
UKC 208	35	100	30	2.5	46	UK 208	C208	H308 HE308 HS308	1.32
	1- ¹ / ₄	3.9370	1- ³ / ₁₆	0.098	1.811				
	1- ³ / ₈								
UKC 209	40	110	31	2.5	50	UK 209	C209	H309 HA309 HE309 HS309	1.64
	1- ⁷ / ₁₆								
	1- ¹ / ₂	4.3307	1- ⁷ / ₃₂	0.098	1.969				
	1- ⁵ / ₈								
UKC 210	45	120	33	2.5	55	UK 210	C210	H310 HS310 HA310 HE310	2.07
	1- ⁵ / ₈								
	1- ¹¹ / ₁₆	4.7244	1- ¹⁹ / ₆₄	0.098	2.165				
	1- ³ / ₄								
UKC 211	50	125	35	2.5	59	UK 211	C211	H311 HS311 HA311 HE311	2.33
	1- ⁷ / ₈								
	1- ¹⁵ / ₁₆	4.9213	1- ³ / ₈	0.098	2.323				
	2								
UKC 212	55	130	38	2.5	62	UK 212	C212	H312 HS312	2.57
	2- ¹ / ₈	5.1181	1- ¹ / ₂	0.098	2.441				
UKC 213	60	140	40	3	65	UK 213	C213	H313 HA313 HE313 HS313	2.89
	2- ³ / ₁₆								
	2- ¹ / ₄	5.5118	1- ³⁷ / ₆₄	0.118	2.559				
	2- ³ / ₈								