

Flange Units (Square)
(Adapter mounted)

UKF 2 (normal-duty)

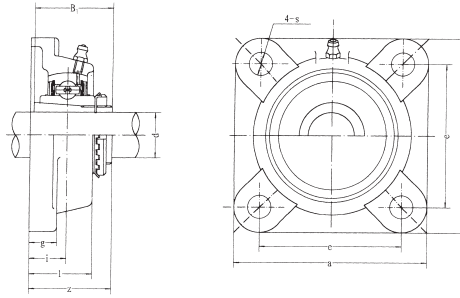

Unit No.	Dimensions <small>mm inch</small>									Bolt Size <small>mm inch</small>	Bearing No.	No.	Housing No.	Weight (kg)
	d	a	e	i	g	l	s	z	B ₁					
UKF 205	20 <small>3/4</small>	95 <small>3-3/4</small>	70 <small>2-3/4</small>	16 <small>5/8</small>	14 <small>35/64</small>	27 <small>1-1/6</small>	12 <small>15/32</small>	35.5 <small>1-25/64</small>	35 <small>1.378</small>	M10 <small>3/8</small>	UK 205	H305 HE305	F205	0.85
UKF 206	25 <small>7/8</small> 1	108 <small>4-1/4</small>	83 <small>3-17/64</small>	18 <small>45/64</small>	14 <small>35/64</small>	31 <small>1-7/32</small>	12 <small>15/32</small>	39 <small>1-17/32</small>	38 <small>1.496</small>	M10 <small>3/8</small>	UK 206	H306 HS306 HE306	F206	1.16
UKF 207	30 <small>1-1/8</small>	117 <small>4-39/64</small>	92 <small>3-5/8</small>	19 <small>3/4</small>	16 <small>5/8</small>	34 <small>1-11/32</small>	14 <small>35/64</small>	42.5 <small>1-43/65</small>	43 <small>1.693</small>	M12 <small>7/16</small>	UK 207	H307 HS307	F207	1.55
UKF 208	35 <small>1-1/4</small> <small>1-3/8</small>	130 <small>5-1/8</small>	102 <small>4-1/64</small>	21 <small>53/64</small>	16 <small>5/8</small>	36 <small>1-27/64</small>	16 <small>5/8</small>	46.5 <small>1-53/64</small>	46 <small>1.811</small>	M14 <small>1/2</small>	UK 208	H308 HE308 HS308	F208	1.94
UKF 209	40 <small>1-7/16</small> <small>1-1/2</small> <small>1-5/8</small>	137 <small>5-13/32</small>	105 <small>4-9/64</small>	22 <small>55/64</small>	18 <small>23/32</small>	38 <small>1-1/2</small>	16 <small>5/8</small>	48.5 <small>1-29/32</small>	50 <small>1.969</small>	M14 <small>1/2</small>	UK 209	H309 HA309 HE309 HS309	F209	2.30
UKF 210	45 <small>1-5/8</small> <small>1-11/16</small> <small>1-3/4</small>	143 <small>5-5/8</small>	111 <small>4-3/8</small>	22 <small>55/64</small>	18 <small>23/32</small>	40 <small>1-9/16</small>	16 <small>5/8</small>	50 <small>1-31/32</small>	55 <small>2.165</small>	M14 <small>1/2</small>	UK 210	H310 HA310 HE310 HS310	F210	2.59
UKF 211	50 <small>1-7/8</small> <small>1-15/16</small> 2	162 <small>6-3/8</small>	130 <small>5-1/8</small>	25 <small>63/64</small>	20 <small>25/32</small>	43 <small>1-11/16</small>	19 <small>3/4</small>	54.5 <small>2-9/64</small>	59 <small>2.323</small>	M16 <small>5/8</small>	UK 211	H311 HA311 HE311 HS311	F211	3.46
UKF 212	55 <small>2-1/8</small>	175 <small>6-57/64</small>	143 <small>5-5/8</small>	29 <small>1-9/64</small>	20 <small>25/32</small>	48 <small>1-57/64</small>	19 <small>3/4</small>	61 <small>2-13/32</small>	62 <small>2.441</small>	M16 <small>5/8</small>	UK 212	H312 HS312	F212	4.33
UKF 213	60 <small>2-3/16</small> <small>2-1/4</small> <small>2-3/8</small>	187 <small>7-23/64</small>	149 <small>5-55/64</small>	30 <small>1-3/16</small>	22 <small>55/64</small>	50 <small>1-31/32</small>	19 <small>3/4</small>	64 <small>2-33/64</small>	65 <small>2.559</small>	M16 <small>5/8</small>	UK 213	H313 HA313 HE313 HS313	F213	4.90
UKF 215	65 <small>2-7/16</small> <small>2-1/2</small>	200 <small>7-7/8</small>	159 <small>6-17/64</small>	32 <small>1-11/32</small>	22 <small>55/64</small>	56 <small>2-7/32</small>	19 <small>3/4</small>	71 <small>2-51/64</small>	73 <small>2.874</small>	M16 <small>5/8</small>	UK215	H315 HA315 HE315	F215	7.02
UKF 216	70 <small>2-11/16</small> <small>2-3/4</small>	208 <small>8-3/16</small>	165 <small>6-1/2</small>	34 <small>1-11/32</small>	22 <small>55/64</small>	58 <small>2-9/32</small>	23 <small>29/32</small>	73.5 <small>2-57/64</small>	78 <small>3.071</small>	M20 <small>3/4</small>	UK216	H316 HA316 HE316	F216	7.76
UKF 217	75 <small>2-15/16</small> 3	220 <small>8-21/32</small>	175 <small>6-57/64</small>	36 <small>1-27/64</small>	24 <small>15/16</small>	63 <small>2-15/32</small>	23 <small>29/32</small>	77 <small>3-1/32</small>	82 <small>3.228</small>	M20 <small>3/4</small>	UK217	H317 HA317 HE317	F217	10.08
UKF 218	80 <small>3-3/16</small>	235 <small>9-1/4</small>	187 <small>7-23/64</small>	40 <small>1-37/64</small>	24 <small>15/16</small>	68 <small>2-11/16</small>	23 <small>29/32</small>	81.5 <small>3-13/64</small>	86 <small>3.386</small>	M20 <small>3/4</small>	UK218	H318 H3A18	F218	12.44